



RKSfluid®

A key Valve in Flow Control



Butterfly Valve



Ball Valve



Gate Valve



Globe Valve



Check Valve



Pipe Fittings

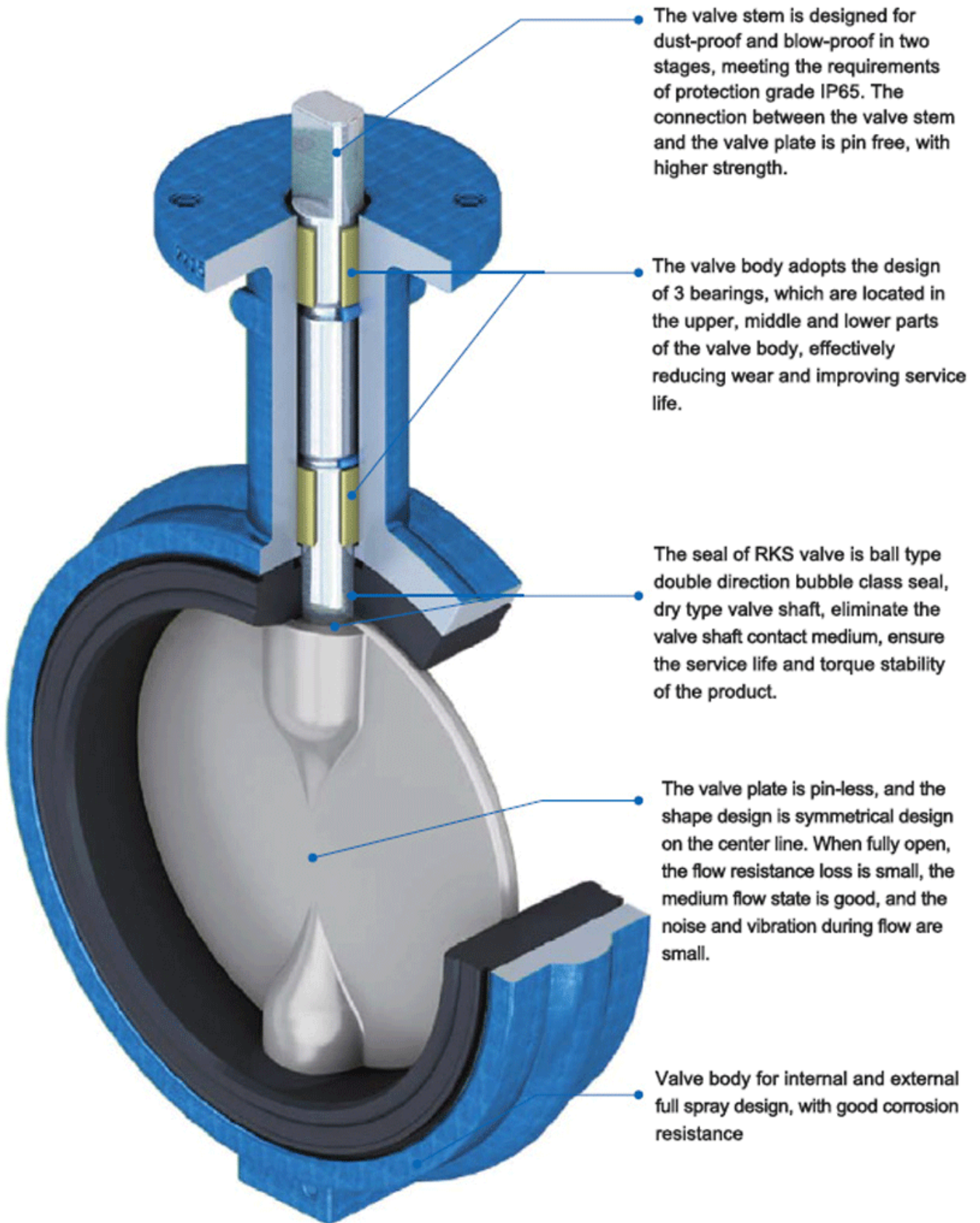

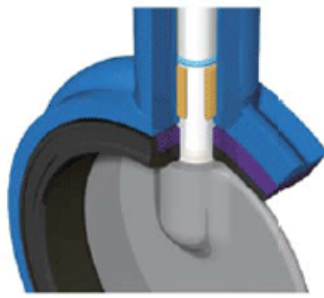
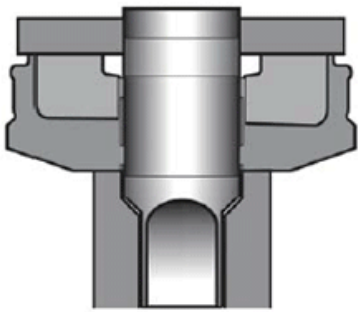

The composite seat of the RKS valve is formed by permanently gluing an elastomer to a rigid gasket ring. In addition to superior seal integrity, this design makes valve installation easier while reducing high torque and premature failure due to rubber deformation. Modular design simplifies seat replacement and ensures economical maintenance

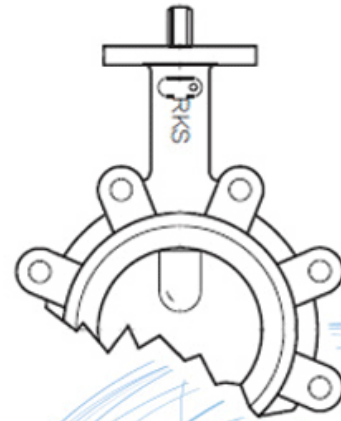

APPLICATION SCENARIO



Industrial water application



Power plant



Sea water desalination



Water treatment



Water supply and drainage



HAVC



Food and drug



Water transport





Our Factory

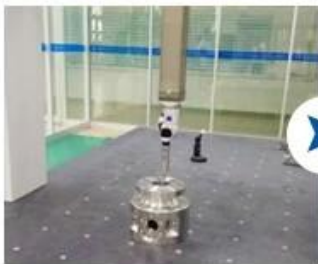

Company Advantages



i

ii

iii

iv

v GB TUV CE ISO 9001 ADWO-2000 TS PED WRC WRA KTW API 6D API609

Exhibition Photos



Our Certificates



□□□□□□□□□□□□□□□□

- □□□□□□□□□□□□□□□□□□□□

□□□□□□□□□□□□□□

- □□□□□□□□Hrdraulic□□□□□ RKSfluid□□□□□□□□□□□□□□□□□□□□

□□□□□□□□□□□□

□□RKSfluid□□□□□□□□□□□□□□□□

□□□□□□□□

□□□□□□□□2□5□□□□□□□□□□□□□□□□□□□□□□□□

□□Moq.

A□□□□□□□1PC□

□□□□□□□□□□

- □□□□□□100□□□□□□□□□□2□□□□□□□□□□□□□□□□□

□□□□□TUV□API□WRA□CE□ISO□□□□

□□□□□DIN□ASME□BS EN□JIS□API□AWWA□

□□□□□□□□□□□□□□□□

□□RKSfluid□□20□□□□□□70□□□□□□□□□□□□□□□□□□□□□□□□□□□□