



- Streamlined, minimum noise
- Backflow velocity only 0.2s, Head loss 0.1bar with 2m/s
- EPDM/NBR Rubber fully coated disc
- Anti-erosion design, Self-adjusting ball
- Self-cleaning stem, Long time smooth operation

Engineering Projects





| Name | Material |
|--------|--------------|
| Body | Ductile iron |
| Ball | NBR |
| O-Ring | NBR |
| Cover | Ductile iron |
| Gasket | SS304 |
| Washer | SS304 |
| Nut | SS304 |

Ball Check Valve, Threaded

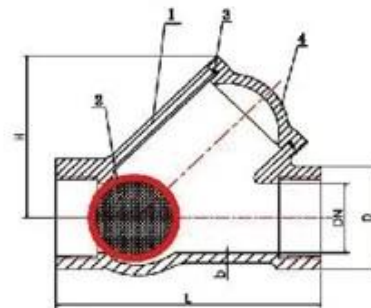
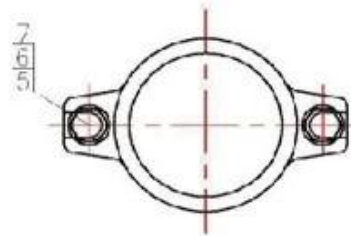

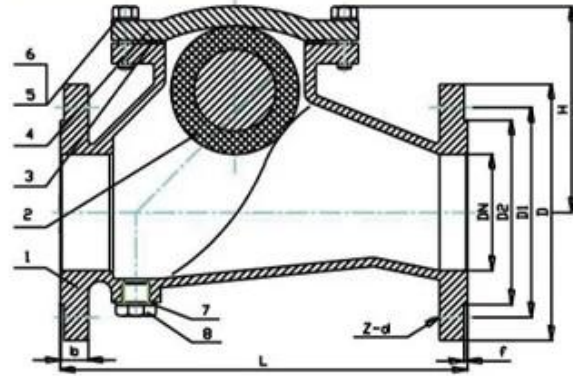

Ball Check Valve, Flange

| Name | Material |
|--------|--------------|
| Body | Ductile iron |
| Ball | NBR |
| Gasket | NBR |
| Body | Ductile iron |
| Bolt | SS304 |
| Washer | SS304 |
| Washer | Nylon |
| Plug | SS304 |

COMPANY INFORMATION



Advanced CNC Machining Center

Advanced CNC Machining Center Professional Process Cells

China

Cention

GB American Standard Tuv CE ISO 9001 ADWO-2000 TS PED WRC WRA KTW API 6D API609

VI

01

21 years of professional experience

03

Independent research and development team
28 top senior professional researchers

05

100% high level ex-factory inspection

07

2 years quality assurance, repair and replacement

4 factories

02

2 professional testing centers

04

High quality imported materials

06

COMPANY QUALIFICATION



COMPANY EXHIBITION



Partners



✘

□□□□□□

Q□□□□□□□□□□□□□□□□□□□□□□□□□□
A□□□□□□□□□□□□□□□□□□□□□□□□□□□□□□

Q□□□□□□□□□□□□□□□□□□□□□□□□□□□
A□□□□□□□□ Hrdraulic□□□□□□□□□□ RKSfluid□□□□□□□□□□ USA□□□□□□□□□□□□□□□□□□□□□□□□□□□□□□□□□□□□□□

Q

A RKSfluid 4

Q

A 2 5

Q Moq

A 1 PC

Q

A 100 2

TUV API WRA CE ISO

Standard DIN ASME BS EN JIS API AWWA

Q

A RKSfluid 20 70 R D