

The **needle valve** (piston-type regulating valve) is specially designed for precise flow control, energy dissipation, and cavitation reduction under high differential pressure and large flow conditions. It uses a piston-shaped needle to adjust the flow area gradually, enabling linear flow regulation and smooth pressure reduction.

**Feature:**

1. Precisely machined stainless steel needle for high splitting accuracy
2. Multi-jet outlet design for effective energy dissipation and cavitation prevention
3. Dual sealing design (metal-to-metal and soft seal)
4. Fully simulated flow channel design for optimized hydraulic performance
5. Multiple actuator options (electric, worm gear, pneumatic, hydraulic)
6. Customizable internal structures for various working conditions

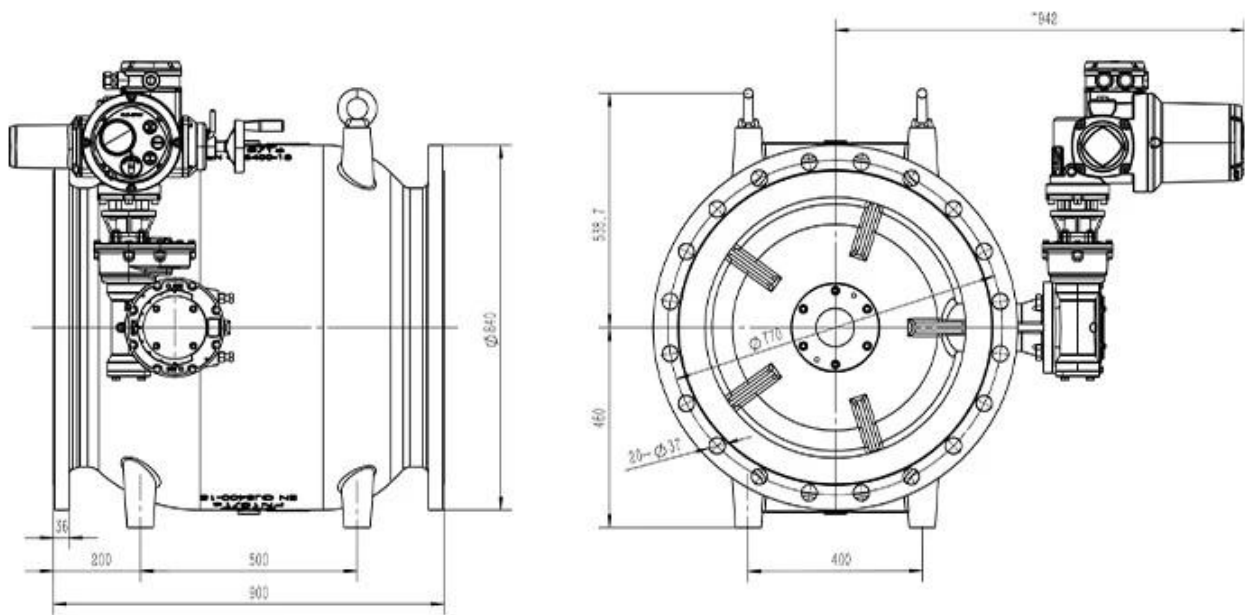



## COMPANY INFORMATION

---



- I Business area: fluid control products, technology and environmental protection products.
- II Advanced CNC machining centers, professional process cells, wide-range welding equipment, automatic assembly lines and coating.
- III China's standard reference unit, to participate in the development of relevant valve industry standards.
- IV We have set up a research and development center in Houston, Texas, in the United States.
- V Product Standard: ISO, CE, PED, WRAS, EN1074, EAC, ASME, and other certifications.
- VI Main production: butterfly valve, ball valve, gate valve, check valve, Air valve, globe valves, pipe fittings, manual / pneumatic / electric actuator, valve parts.





## COMPANY EXHIBITION



## COMPANY QUALIFICATION





## **FAQ:**

### **Q1: How long is the delivery time?**

A1: Generally it's 5-10 days we have stock. Or it's 15-90 days depend on different product and quantity.

### **Q2: What about the payment term?**

A2: T/T 30% deposit, balance payment after finished production before shipment. Or as discussed.

### **Q3: Can I have a sample order?**

A3: Yes, we agree sample order, mixed different models is also acceptable.

### **Q4: What's your MOQ?**

A4: We can support 1 pc order. Welcome you to check our quality.

### **Q5: What's your quality inspection? Do you test all your goods before delivery?**

A5: Yes, 100% test. It integrates R&D, casting, production, processing, painting, assembly, testing, sales and after-sales service, and strict quality requirements, according to GB, ASME, API, DIN standard, and we have gained ISO, CE, PED, WRAS, EN1074, EAC, ASME, and other certifications.

### **Q6: Could I customize special request valve or new design products?**

A6: We have own R&D team and more than 70 researchers and engineers. Can give you the best support on quality management and techniques, meet your different needs.

### **Q7: How does your factory do regarding quality control?**

A7: Quality is priority. Valve always attach great importance to quality controlling from the very beginning to the very end. Our factory has gained ISO9001;2008, CE, TUV, authentication.