



This product are used for accessories such as pipelines, faucets and other pipelines installed on the DI pipelines which have been installed.

High-strength bolts can be supplied, Install easily and remove conveniently. It can be non-stop to install the product.

The main function of this product is to open a branch pipe or install the faucet or water meter in any part of the pipeline temporarily after the completion of the installation of the whole pipeline and already running.

Quick removal of the product, the installation of only one wrench, torque wrench to tighten high-strength steel or stainless steel connection bolt is one of the most important features of the series.

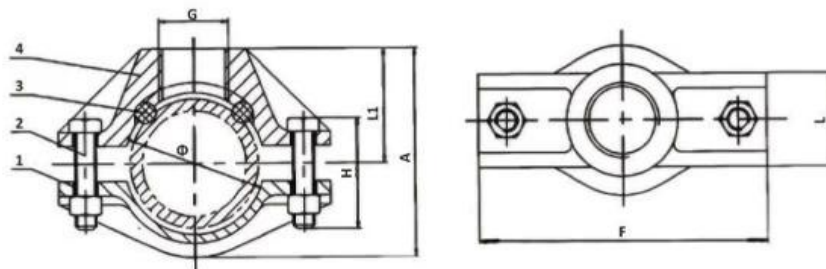

NO.	Name	Material	Standard
1	Body cover	GGG50	EN1563
2	Bolt	Stainless Steel 304	EN1563
3	Rubber Ring	EPDM	ISO4633
4	Body	GGG50	ISO898
5/6/7	Anti-corrosion Coating	Epoxy Resin	BS EN 14901



COMPANY INFORMATION



- I Business area: fluid control products, technology and environmental protection products.
- II Advanced CNC machining centers, professional process cells, wide-range welding equipment, automatic assembly lines and coating.
- III China's standard reference unit, to participate in the development of relevant valve industry standards.
- IV We have set up a research and development center in Houston, Texas, in the United States.
- V Product Standard: GB, German Standard, American Standard, TUV CE, ISO 9001, ADWO-2000, TS, PED, WRC WRAS, KTW, API 6D, API609.
- VI Main production: butterfly valve, ball valve, gate valve, check valve, Air valve, globe valves, pipe fittings, manual / pneumatic / electric actuator, valve parts.



COMPANY EXHIBITION



COMPANY QUALIFICATION



Delivery



Payment



FAQ:

Q1: How long is the delivery time?

A1: Generally it's 5-10 days we have stock. Or it's 15-90 days depend on different product and quantity.

Q2: What about the payment term?

A2: T/T 30% deposit, balance payment after finished production before shipment. Or as discussed.

Q3: Can I have a sample order?

A3: Yes, we agree sample order, mixed different models is also acceptable.

Q4: What's your MOQ?

A4: We can support 1 pc order. Welcome you to check our quality.

Q5: What's your quality inspection? Do you test all your goods before delivery?

A5: Yes, 100% test. It integrates R&D, casting, production, processing, painting, assembly, testing, sales and after-sales service, and strict quality requirements, according to GB, ASME, API, DIN standard, and we have gained ISO9001;2008, CE, and TUV certification.

Q6: Could I customize special request valve or new design products?

A6: We have own R&D team and more than 70 researchers and engineers. Can give you the best support on quality management and techniques, meet your different needs.

Q7: How does your factory do regarding quality control?

A7: Quality is priority. Valve always attach great importance to quality controlling from the very beginning to the very end. Our factory has gained ISO9001;2008, CE, TUV, authentication.